

Product Data Sheet

Check Valve



Key features

- In-line poppet type
- Allows flow in one direction only, closing when flow reverses
- Max temperature 200°C
- VITON seats (VITON 90 available for NACE, KALREZ also available if required)
- NPT female X female connections

General Arrangement Drawing

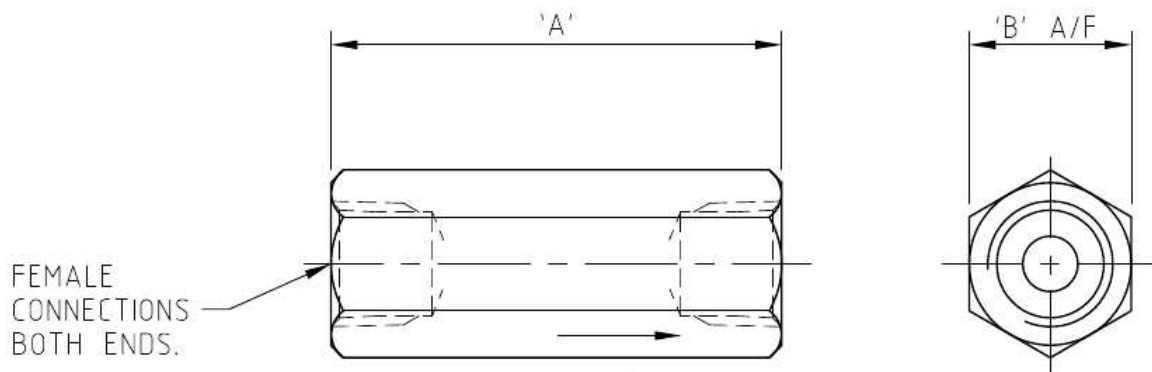

| Sizes | Part No | Max Pressure | Cracking Pressure | A | B | Weight | CV (Max) |
|-------|---------|--------------|-------------------|-------|-------|--------|----------|
| 1/4" | CV25S | 6,000 PSI | 7 PSI | 0.87" | 2.31" | 0.2kg | 0.7 |
| 3/8" | CV38S | 6,000 PSI | 7 PSI | 1.10" | 2.50" | 0.3kg | 0.7 |
| 1/2" | CV50S | 6,000 PSI | 7 PSI | 1.10" | 3.06" | 0.3kg | 2.0 |
| 3/4" | CV75S | 6,000 PSI | 4 PSI | 1.63" | 3.63" | 0.8kg | 4.6 |
| 1" | CV10S | 6,000 PSI | 4 PSI | 2.05" | 4.19" | 0.9kg | 7.2 |

Rev 1.1